

Composite dry sliding bushings, metric dimensions

Principal dimensions			Basic load ratings		Mass	Designation
d	D	B	dynamic C	static C0		
mm			kN		kg	-
<b>5</b>	7	8	3,2	10	0,0011	PCM 050708 E

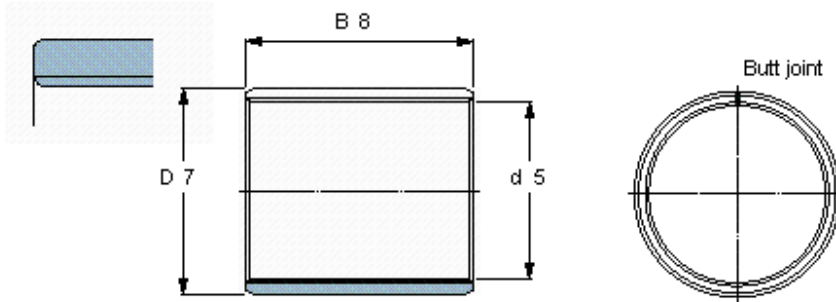

**Specific load factor** K 80  
**Material constant**  $K_M$  480